

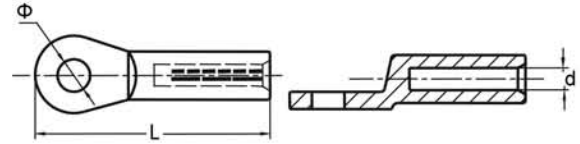

DIN ALUMINIUM LUG

AU



Material: Al-99.5%
 Surface treatment: Tin-plated mini 15 microns
 Product Property: It is in accordance with DIN 46329 with markings for correct crimping. And its barrel capped is filled with joint compound to avoid oxidization. And its type test is follow IEC 61238-1.

Type	Dimensions(mm)		
	L	d	φ
AU16-8	60	5.8	8.4
AU25-8	61.5	6.8	8.4
AU25-10	61.5	6.8	10.5
AU35-10	77	8	10.5
AU50-10	77	9.8	10.5
AU50-12	77	9.8	13
AU70-10	84.5	11.2	10.5
AU95-12	88	13.2	13

Type	Dimensions(mm)		
	L	d	φ
AU120-12	95	14.7	13
AU150-12	105	16.3	13
AU150-16	105	16.3	17
AU185-12	106	18.3	13
AU185-16	106	18.3	17
AU240-12	122	21	13
AU240-16	122	21	17
AU300-16	123	23.3	17