

4.3/10 Female (solder) Connector For 1/2" Superflexible Cable

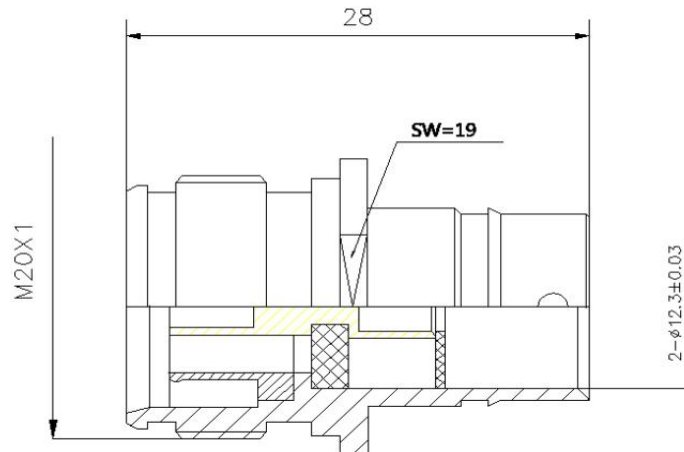

Electrical Specification

| | |
|---------------------------------|---|
| Characteristic Impedance | 50 ohm |
| Frequency Range | DC- 12 GHz |
| VSWR | ≤1.10@DC-3000MHz |
| Contact Resistance | Center contact ≤1mΩ Outer contact ≤1mΩ |
| Dielectric withstanding Voltage | >2500V RMS, 50Hz, At sea Level |
| Dielectric Resistance | ≥5000MΩ |
| RoHS | Compliance |

Mechanical

| | |
|-------------------|------------|
| Durability Mating | cycle ≥100 |
|-------------------|------------|

Material Specification

| | Material | Plating |
|------------------|-----------------|-------------|
| Body | Brass | Tri - alloy |
| Insulator | PTFE | |
| Center Conductor | Phosphor Copper | Ag |

Environmental

| | |
|-------------------|-----------------|
| Temperature Range | - 40°C – +85 °C |
|-------------------|-----------------|