

Synergy Telecom P Ltd.

Part No- ST02SSFFRA18

SMA FEMALE TO SMA FEMALE RA ADPATOR

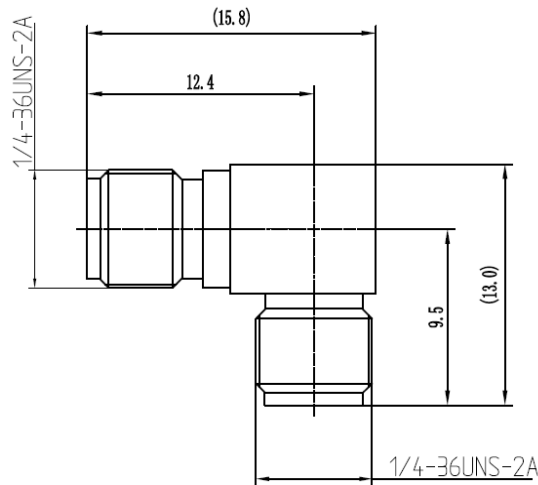

Tolerance +/- 2mm

Electrical:

| | |
|--|--------------------------|
| Characteristic Impedance | 50 ohm |
| Frequency Range | DC-18 Ghz |
| VSWR | ≤1.20@DC-18GHz |
| Insertion Loss | ≤0.3 dB |
| Dielectric withstanding Voltage | ≥1000V Vrms at Sea Level |
| RF high potential withstanding Voltage | ≥500V Vrms at 5Mhz |
| Insulation Resistance | ≥3000 MOhm |

Mechanical:

| | |
|------------|--------------------|
| Durability | Mating Cycles ≥500 |
|------------|--------------------|

Material and Plating:

| | Material | Plating |
|------------------|------------------|-----------------------|
| Body | Stainless Steel | Polished & Passivated |
| Insulator | PEI | |
| Center conductor | Beryllium Copper | Gold |

Environmental:

| | |
|-----------------------------|----------------|
| Operating Temperature Range | -55°C ~ +165°C |
| RoHs | Compliant |

WZ-47 BUDHELLA VILLAGE ,VIKASPURI NEW DELHI-110018
Phone: 011-28533349, Mob: 9810138894/9212558066, Fax: 011-28533349
Email:- info@rfconnector.in, Website:- www.rfconnector.in