

# Synergy Telecom P Ltd.

## 700-3800MHz Directional Coupler

Operating Frequency( MHz )	700-3800					
Impedance( Ohm )	50					
VSWR	≤1.25					
IM3 (dBc @ 2x43dBm)	-163					
Application	Indoor					
Handling Power(Watt, max)	300					
Peak Power(Watt, max)	1200					
Interface	N Female					
Operating Temperature( °C )	-40 ~ + 80					
Connector Material	Copper alloy or Zinc alloy					
Body Material	Aluminum					
INX in P/N	IN5	IN6	IN7	IN10	IN15	IN20
Coupling(dB)	5	6	7	10	15	20
Coupling Tolerance(dB)	±0.8	±0.8	±0.9	±1.0	±1.0	±1.2
Insertion Loss(dB)	2.10	1.65	1.45	1.0	0.5	0.22
Isolation(dB)	≥23	≥24	≥25	≥28	≥33	≥38
Dimensions ( mm,LxWxH,excluding connector )	132x40x17					

## 700-3800MHz Directional Coupler



3D Drawing

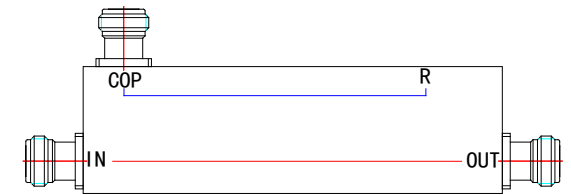
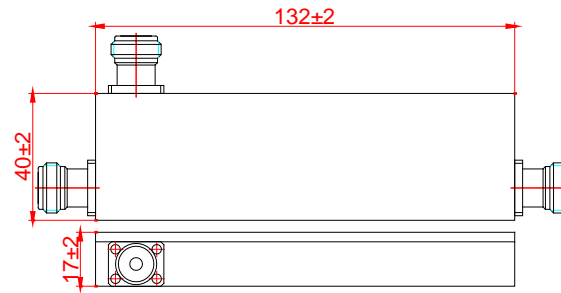

IN→OUT : DC PASS  
IN→COP : NON-DC PASS  
OUT→COP : NON-DC PASS

Outline Drawing