

Synergy Telecom P Ltd.

HT16 系列耐高温连接器

Series HT16 high temperature Connector

HT16系列耐高温连接器特别适用于石油深井高温条件下所使用的电子测试设备或仪器中连接测试电路。

Series Ht16 high temperature connectors are especially suitable to connect test circuits in electronic test equipment and apparatus for petroleum deep well.



技术特性

TECHNICAL CHARACTERISTICS

使用环境条件 Environment condition			
环境温度 Temperature range	-55℃~+200℃	相对湿度 Relative humidity	+40±2℃时,达 95%~98% Up to 95%~98% , at+40±2℃
振动 Vibration	振频10~2000Hz时, 加速度达15g Acceleration up to 15g at 10~2000Hz	工作电压 Working voltage	380V
工作电流 Working current	3A		

主要技术特性 Key technical Performance			
单脚分离力 Withdrawl force of per contace pair	正常条件下0.1~0.3kgf;+200℃ 6小时高温后不小于0.08kgf 0.1~0.3kgf at normal condition; 0.08kgf,6 hours late after high temperature test at +200℃	接触电阻 Contact resistance	不大于0.005Ω ≤0.005Ω
绝缘电阻隔 Insulation resistance	正常条件下, 不小于1000MΩ; +200℃ 条件下, 6小时后不小于100MΩ; ≥1000MΩ,at normal condition;≥1000MΩ,6 hours late after high temperature test at +200℃	试验电压 Test Voltage	正常条件下1500V; 高温+200℃ 试验后6小时之后, 100V; 潮湿试验后1000V 1500V,at normal condition;1000V,6hours late after high temperature test at +200℃ ; 1000V,after humidify test.
寿命 Durability	500次 500cycles		

产品型号表 Product type

接触对分布状况 Contact pair ditribution	线数 Contact NO	型号 Type	
		插座 Receptacle	插头 Plug
	4	HT16J4APJ	HT16K4PJ
		HT16K4APJ	HT16J4PJ
	7	HT16J7APJ	HT16K7PJ
		HT16K7APJ	HT16J7PJ

Synergy Telecom P Ltd.

直式电缆插针/插孔 插头
Straight cable pin/socket Plug

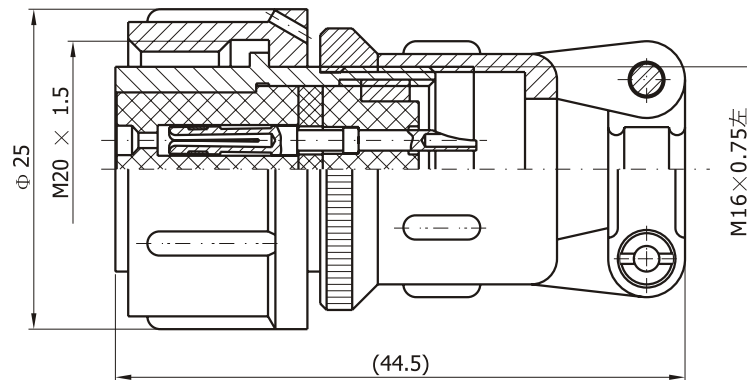

直式面板插针/插孔 插座
Straight panel pin/socket receptacle

